



**POLYTECHNIC UNIVERSITY OF THE PHILIPPINES
COLLEGE OF ENGINEERING
COMPUTER ENGINEERING DEPARTMENT**

PUP Communication Tracking System
2016 9542 85
Tracking Number



1
A-1
COLLEGE OF COMMUNICATION MEDICAL CLINIC
PERSPECTIVE



3
A-1
COLLEGE OF ENGINEERING & ARCHITECTURE MEDICAL CLINIC
PERSPECTIVE



2
A-1
COLLEGE OF COMMUNICATION DENTAL CLINIC
PERSPECTIVE

Republic of the Philippines POLYTECHNIC UNIVERSITY OF THE PHILIPPINES Sta. Mesa, Manila	PROJECT TITLE IMPROVEMENT OF CEA MEDICAL, CDC MEDICAL & DENTAL, INSTITUTE OF TECHNOLOGY MEDICAL AND TAGURG MEDICAL AND DENTAL CLINIC CREATED FOR THE NEW CAMPUS OF PUP STA. MESA COMPOUND	PROJECT LEAD AR. SERGIO C. NIEME DIRECTOR - PUPDC	ALL INFORMATION APPROVED Prof. Alberto C. Gurilo VP FOR ADMINISTRATION	APPROVED BY Dr. Emmanuel C. de Guzman PRESIDENT	SHEET CONTENTS AS SHOWN CHECKED BY: [Signature] DATE: [Blank]	SHEET NO. A-1
---	--	---	--	---	--	------------------

(02) 8713 5968 | dcoe_chair@gmail.com
RM322 CEA BLDG. NDC COMPOUND,
ANONAS COR. PUREZA STREETS, STA. MESA, MANILA





**POLYTECHNIC UNIVERSITY OF THE PHILIPPINES
COLLEGE OF ENGINEERING
COMPUTER ENGINEERING DEPARTMENT**



(02) 8713 5968 | dcoe_chair@gmail.com
 RM322 CEA BLDG. NDC COMPOUND,
 ANONAS COR. PUREZA STREETS, STA. MESA, MANILA





POLYTECHNIC UNIVERSITY OF THE PHILIPPINES
 COLLEGE OF ENGINEERING
COMPUTER ENGINEERING DEPARTMENT

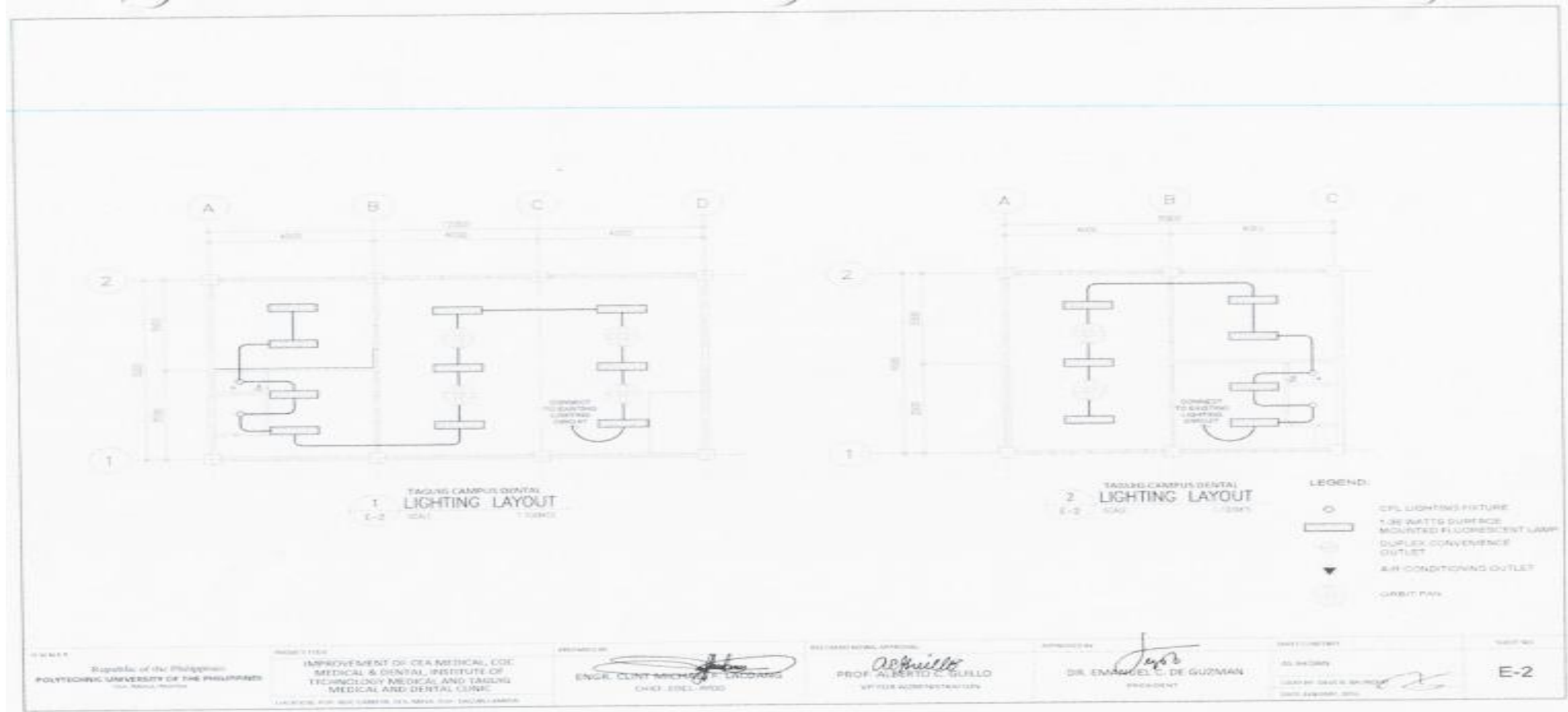

(02) 8713 5968 | dcoe_chair@gmail.com
 RM322 CEA BLDG. NDC COMPOUND,
 ANONAS COR. PUREZA STREETS, STA. MESA, MANILA





**POLYTECHNIC UNIVERSITY OF THE PHILIPPINES
COLLEGE OF ENGINEERING
COMPUTER ENGINEERING DEPARTMENT**

DOOR AND WINDOW SCHEDULE											
DOOR PROFILE	TYPE	DESCRIPTION	DOOR PROFILE	TYPE	DESCRIPTION	WINDOW PROFILE	TYPE	DESCRIPTION	WINDOW PROFILE	TYPE	DESCRIPTION
	SWING TYPE DOOR	FLUSH HOLLOW CORE MARINE PLYWOOD FINISH DOOR W/ DOOR JAMB PAINTED FINISH		SWING TYPE DOOR	FLUSH HOLLOW CORE MARINE PLYWOOD FINISH DOOR W/ DOOR JAMB PAINTED FINISH		AWNING TYPE WINDOW	6MM THK GLASS ON ALUMINUM SLIDING WINDOW PAINTED FINISH		AWNING TYPE WINDOW	6MM THK GLASS ON ALUMINUM SLIDING WINDOW PAINTED FINISH
D 1	2 SETS	MEDICAL & DENTAL CLINIC MAIN ENTRANCE	D 2	4 SETS	DOCTOR'S ROOM HALLWAY	W 1	1 SET	MEDICAL CLINIC	W 2	1 SET	MEDICAL CLINIC
							AWNING TYPE WINDOW	6MM THK GLASS ON ALUMINUM SLIDING WINDOW PAINTED FINISH		AWNING TYPE WINDOW	6MM THK GLASS ON ALUMINUM SLIDING WINDOW PAINTED FINISH
						W 3	2 SETS	DOCTOR'S ROOM	W 4	2 SETS	MEDICAL CLINIC DENTAL CLINIC
<p style="text-align: center;">TAGUIG CAMPUS MEDICAL & DENTAL 1 DOOR AND WINDOW SCHEDULE A-26 1/26</p>											
<p>DATE: Republic of the Philippines POLYTECHNIC UNIVERSITY OF THE PHILIPPINES 1st Floor Manila</p>		<p>PROJECT: IMPROVEMENT OF CEA MEDICAL, ECC MEDICAL & DENTAL, INSTITUTE OF TECHNOLOGY MEDICAL AND TAGUIG MEDICAL AND DENTAL CLINIC. LOCATION: TAGUIG CAMPUS, 114 8802, PUP, TAGUIG CITY</p>		<p>DESIGNED BY: <i>AS. SUSAPAT R. NEVA</i> DIRECTOR - INOC</p>		<p>PREPARED BY: <i>ALBUQUILLO</i> PROP. ALBERTO C. GUALLO VP FOR ADMINISTRATION</p>		<p>APPROVED BY: <i>Jenifer</i> DR. EMANUEL C. DE GUZMAN PRESIDENT</p>		<p>ISSUE NO: 1 DATE: 2024-08-26 SCALE: 1:1</p>	

(02) 8713 5968 | dcoe_chair@gmail.com
RM322 CEA BLDG. NDC COMPOUND,
ANONAS COR. PUREZA STREETS, STA. MESA, MANILA





POLYTECHNIC UNIVERSITY OF THE PHILIPPINES
 COLLEGE OF ENGINEERING
COMPUTER ENGINEERING DEPARTMENT

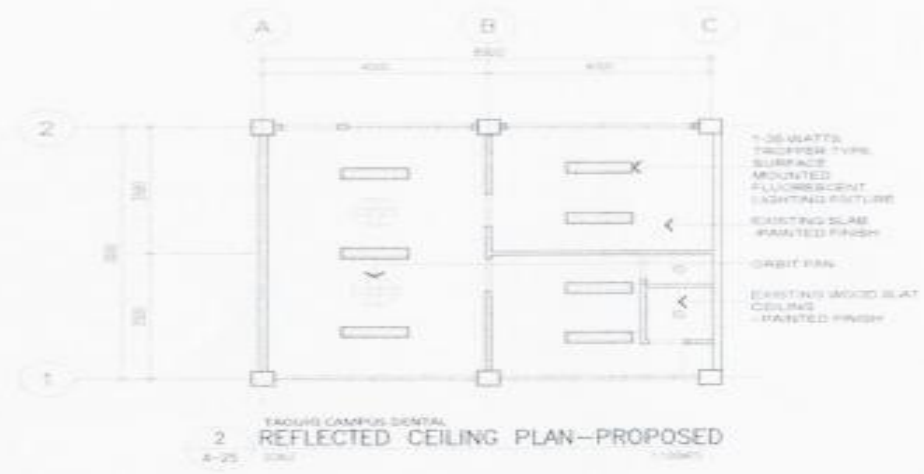
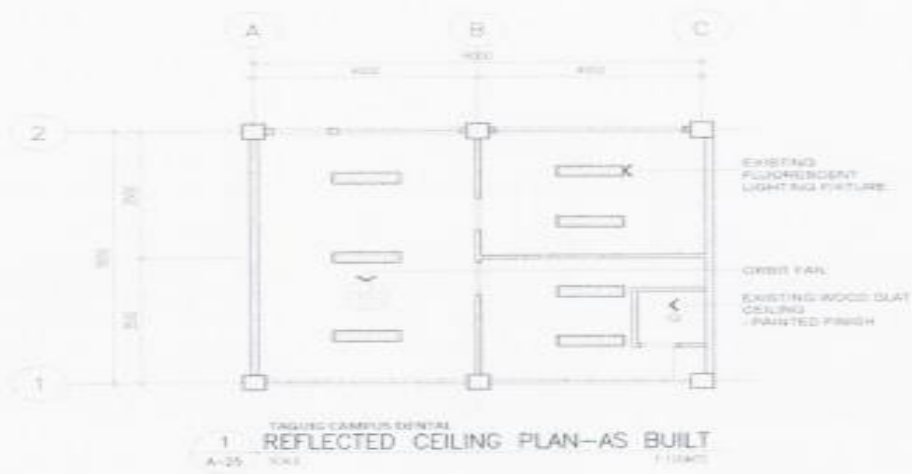

CLIENT Republic of the Philippines POLYTECHNIC UNIVERSITY OF THE PHILIPPINES 1111 Manila, Manila	PROJECT TITLE IMPROVEMENT OF CEA MEDICAL, COE MEDICAL & DENTAL INSTITUTE OF TECHNOLOGY MEDICAL AND TAGUIG MEDICAL AND DENTAL CLINIC LOCATION: PUP NDC COMPOUND, 1111 MANILA, PUP TAGUIG CAMPUS	PROJECT LEAD AR. EMMAUEL C. DE GUZMAN DIRECTOR - PPOC	RECOMMENDATION APPROVAL PROF. ALBERTO C. GUALLO VP FOR ADMINISTRATION	APPROVAL BY DR. EMMAUEL C. DE GUZMAN PRESIDENT	DATE SUBMITTED AS SHOWN 11-08-2015 DATE APPROVED DATE APPROVED 11-08-2015	DRAWING NO. A-25
---	---	---	---	--	--	---------------------

(02) 8713 5968 | dcoe_chair@gmail.com
 RM322 CEA BLDG. NDC COMPOUND,
 ANONAS COR. PUREZA STREETS, STA. MESA, MANILA





POLYTECHNIC UNIVERSITY OF THE PHILIPPINES
 COLLEGE OF ENGINEERING
COMPUTER ENGINEERING DEPARTMENT

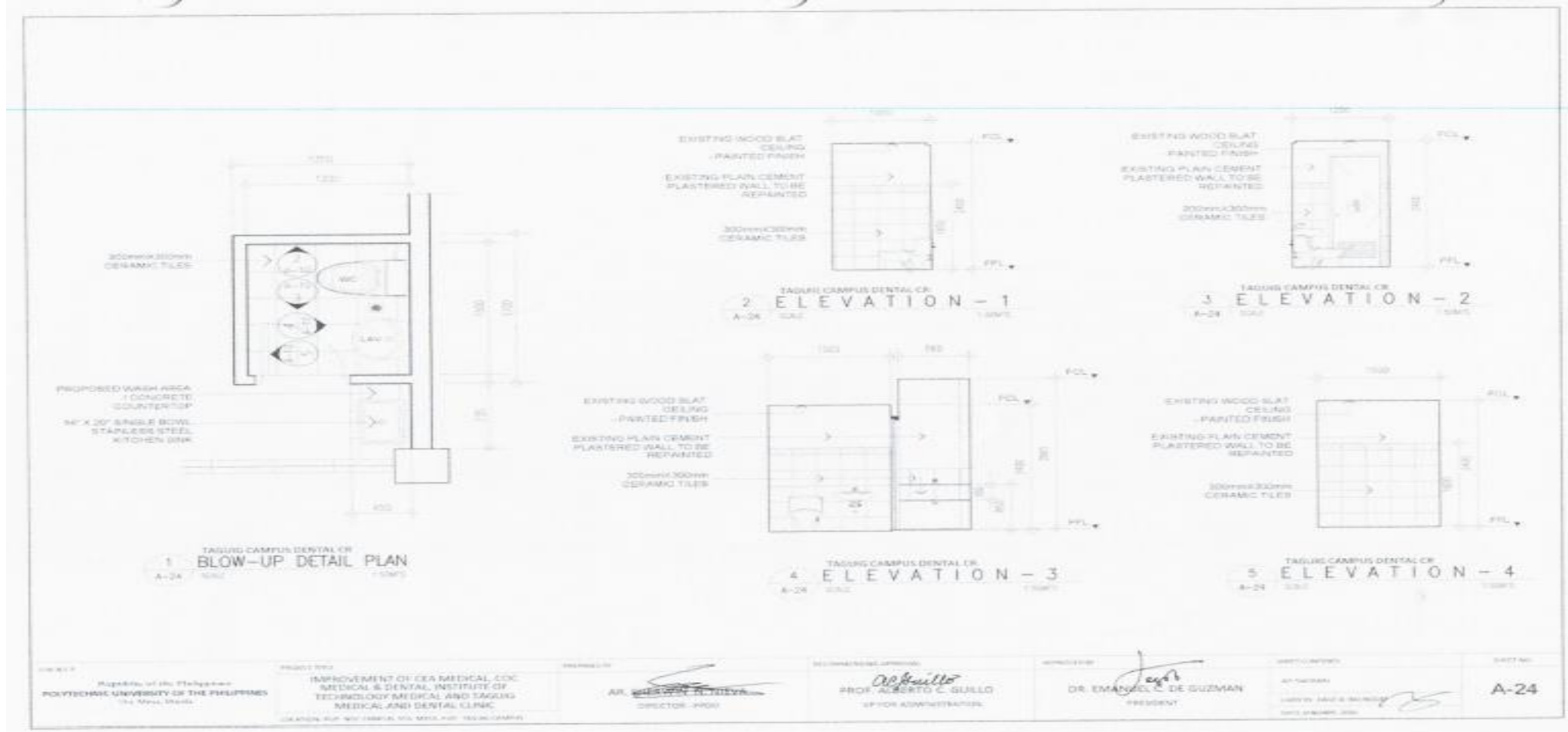

(02) 8713 5968 | dcoe_chair@gmail.com
 RM322 CEA BLDG. NDC COMPOUND,
 ANONAS COR. PUREZA STREETS, STA. MESA, MANILA





POLYTECHNIC UNIVERSITY OF THE PHILIPPINES
 COLLEGE OF ENGINEERING
COMPUTER ENGINEERING DEPARTMENT

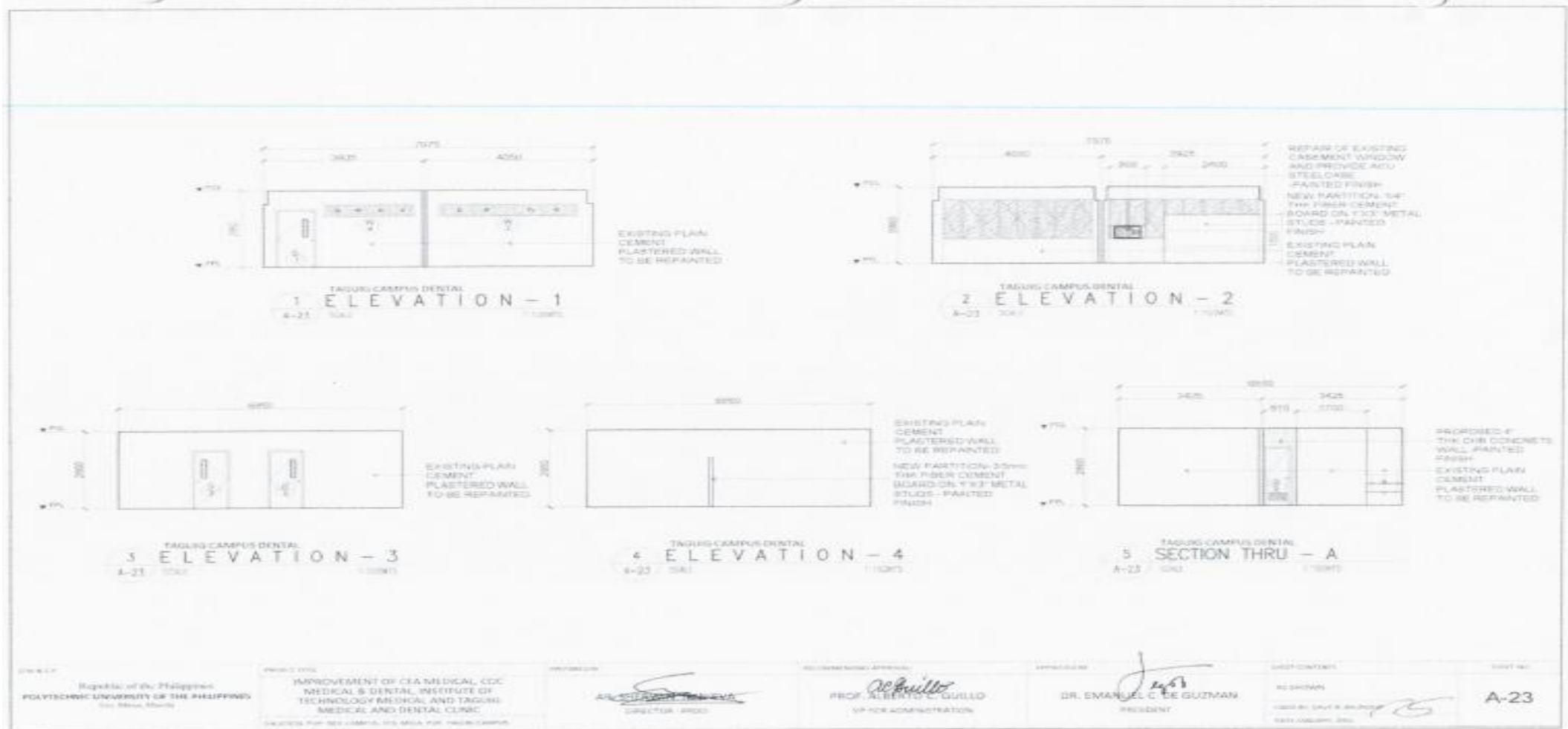

(02) 8713 5968 | dcoe_chair@gmail.com
 RM322 CEA BLDG. NDC COMPOUND,
 ANONAS COR. PUREZA STREETS, STA. MESA, MANILA





POLYTECHNIC UNIVERSITY OF THE PHILIPPINES
 COLLEGE OF ENGINEERING
COMPUTER ENGINEERING DEPARTMENT

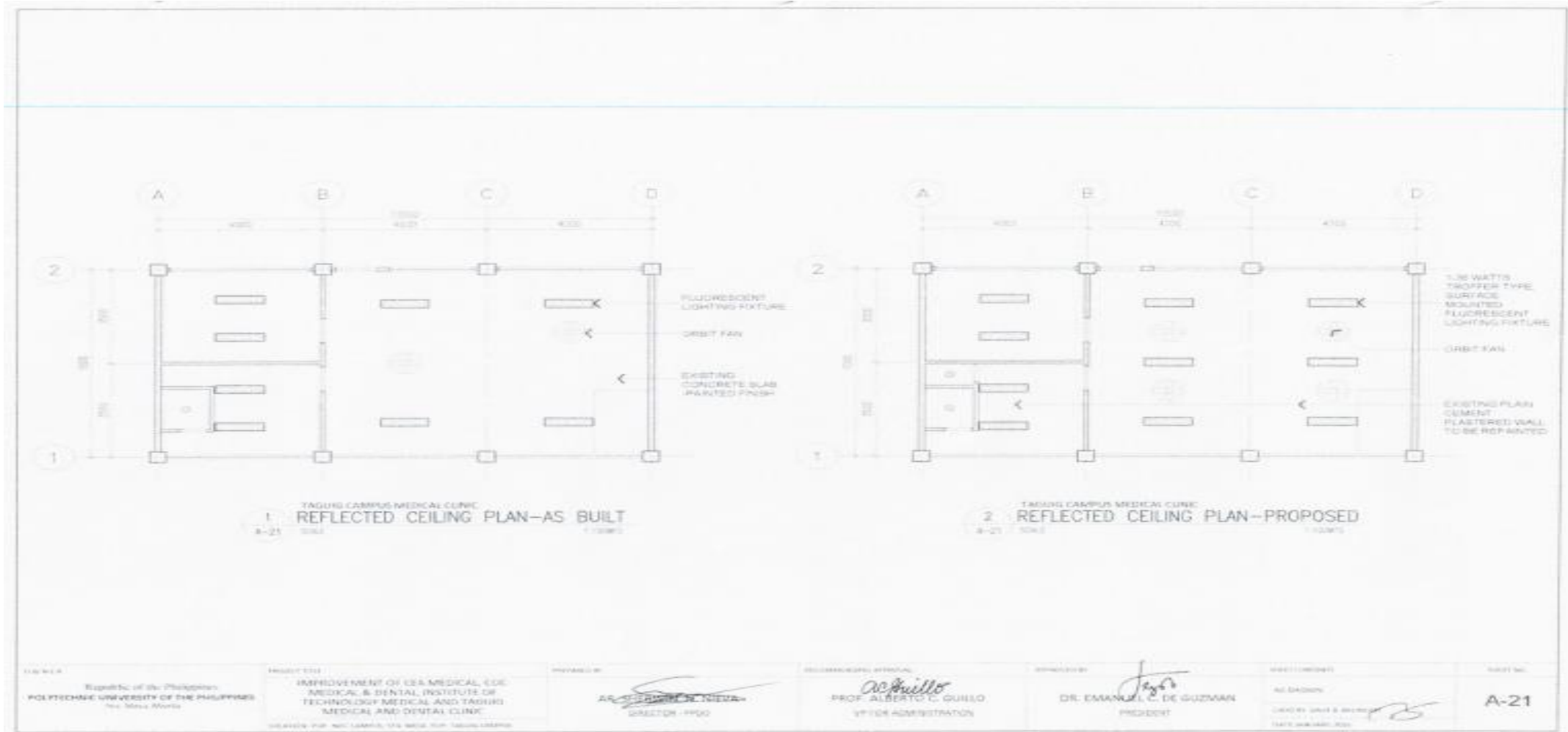

(02) 8713 5968 | dcoe_chair@gmail.com
 RM322 CEA BLDG. NDC COMPOUND,
 ANONAS COR. PUREZA STREETS, STA. MESA, MANILA





POLYTECHNIC UNIVERSITY OF THE PHILIPPINES
 COLLEGE OF ENGINEERING
COMPUTER ENGINEERING DEPARTMENT



(02) 8713 5968 | dcoe_chair@gmail.com
 RM322 CEA BLDG. NDC COMPOUND,
 ANONAS COR. PUREZA STREETS, STA. MESA, MANILA





POLYTECHNIC UNIVERSITY OF THE PHILIPPINES
 COLLEGE OF ENGINEERING
COMPUTER ENGINEERING DEPARTMENT

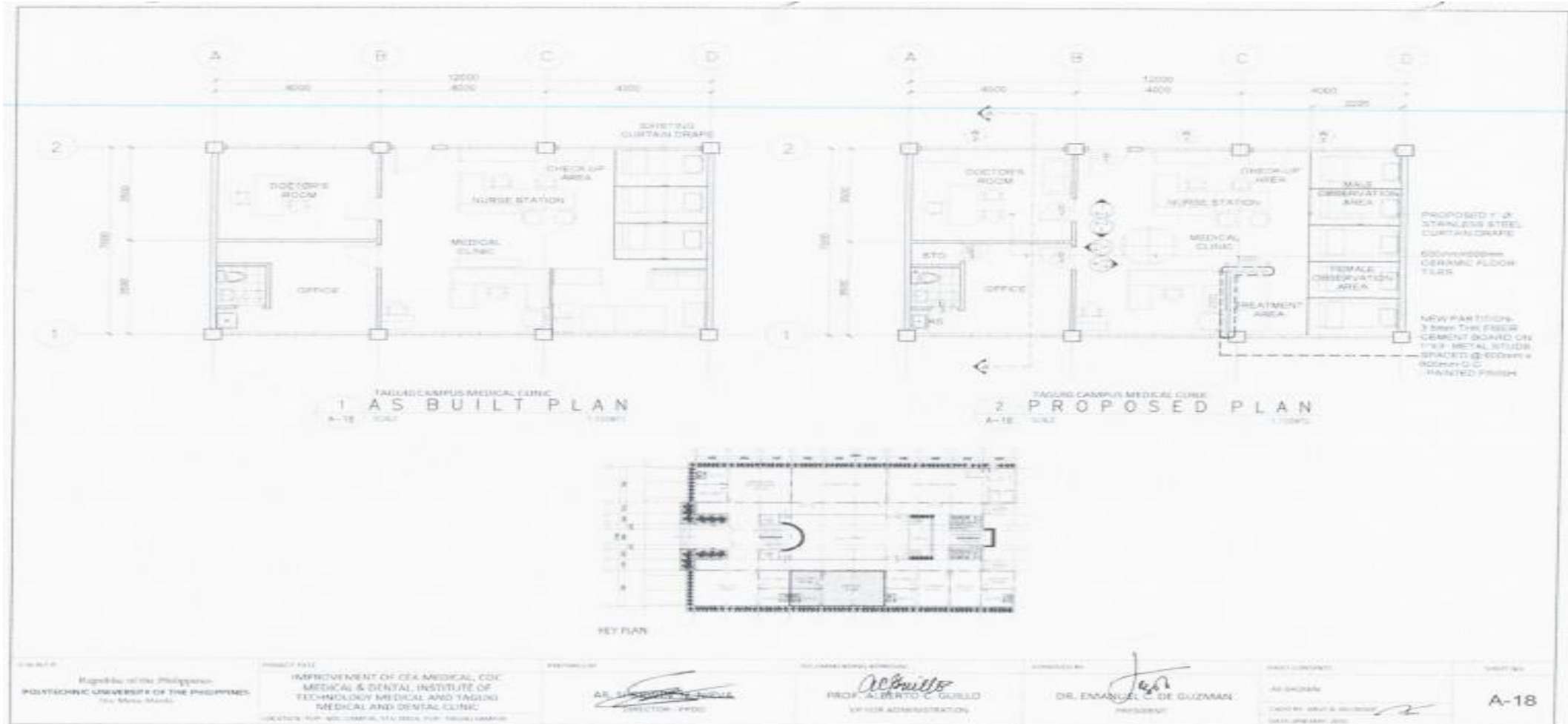

(02) 8713 5968 | dcoe_chair@gmail.com
 RM322 CEA BLDG. NDC COMPOUND,
 ANONAS COR. PUREZA STREETS, STA. MESA, MANILA



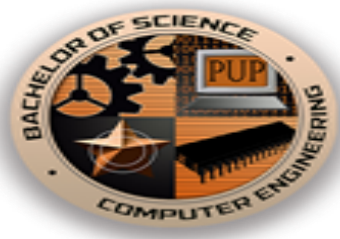

POLYTECHNIC UNIVERSITY OF THE PHILIPPINES
 COLLEGE OF ENGINEERING
COMPUTER ENGINEERING DEPARTMENT

DOOR PROFILE	TYPE	DESCRIPTION	DOOR PROFILE	TYPE	DESCRIPTION	DOOR PROFILE	TYPE	DESCRIPTION
	D1 SWING TYPE PANEL DOOR	PVC DOOR WITH LOUVER		D2 SWING TYPE PANEL DOOR	LOUVER WOODEN DOOR PAINTED FINISH FULL LOUVER		W1 AWNING TYPE WINDOW	6 mm THK CLEAR GLASS PANEL STEEL AWNING TYPE WINDOW PAINTED FINISH
		LOCATION			LOCATION			LOCATION
	QUANTITY	COMFORT ROOM		QUANTITY	UTILITY/ STORAGE ROOM		QUANTITY	COMFORT ROOM
	1 SET			1 SET			1 SET	

INSTITUTE OF TECHNOLOGY MEDICAL
 SCHEDULE OF DOORS AND WINDOW

PUP/CEA Republic of the Philippines POLYTECHNIC UNIVERSITY OF THE PHILIPPINES Sta. Mesa, Manila	PROJECT TITLE IMPROVEMENT OF CEA MEDICAL, CDC MEDICAL & DENTAL, INSTITUTE OF TECHNOLOGY MEDICAL AND TOXICOLOGY MEDICAL AND DENTAL CLINIC 258-A 259, 260, 261, 262, 263, 264, 265, 266, 267, 268, 269, 270, 271, 272, 273, 274, 275, 276, 277, 278, 279, 280, 281, 282, 283, 284, 285, 286, 287, 288, 289, 290, 291, 292, 293, 294, 295, 296, 297, 298, 299, 300, 301, 302, 303, 304, 305, 306, 307, 308, 309, 310, 311, 312, 313, 314, 315, 316, 317, 318, 319, 320, 321, 322, 323, 324, 325, 326, 327, 328, 329, 330, 331, 332, 333, 334, 335, 336, 337, 338, 339, 340, 341, 342, 343, 344, 345, 346, 347, 348, 349, 350, 351, 352, 353, 354, 355, 356, 357, 358, 359, 360, 361, 362, 363, 364, 365, 366, 367, 368, 369, 370, 371, 372, 373, 374, 375, 376, 377, 378, 379, 380, 381, 382, 383, 384, 385, 386, 387, 388, 389, 390, 391, 392, 393, 394, 395, 396, 397, 398, 399, 400, 401, 402, 403, 404, 405, 406, 407, 408, 409, 410, 411, 412, 413, 414, 415, 416, 417, 418, 419, 420, 421, 422, 423, 424, 425, 426, 427, 428, 429, 430, 431, 432, 433, 434, 435, 436, 437, 438, 439, 440, 441, 442, 443, 444, 445, 446, 447, 448, 449, 450, 451, 452, 453, 454, 455, 456, 457, 458, 459, 460, 461, 462, 463, 464, 465, 466, 467, 468, 469, 470, 471, 472, 473, 474, 475, 476, 477, 478, 479, 480, 481, 482, 483, 484, 485, 486, 487, 488, 489, 490, 491, 492, 493, 494, 495, 496, 497, 498, 499, 500, 501, 502, 503, 504, 505, 506, 507, 508, 509, 510, 511, 512, 513, 514, 515, 516, 517, 518, 519, 520, 521, 522, 523, 524, 525, 526, 527, 528, 529, 530, 531, 532, 533, 534, 535, 536, 537, 538, 539, 540, 541, 542, 543, 544, 545, 546, 547, 548, 549, 550, 551, 552, 553, 554, 555, 556, 557, 558, 559, 560, 561, 562, 563, 564, 565, 566, 567, 568, 569, 570, 571, 572, 573, 574, 575, 576, 577, 578, 579, 580, 581, 582, 583, 584, 585, 586, 587, 588, 589, 590, 591, 592, 593, 594, 595, 596, 597, 598, 599, 600, 601, 602, 603, 604, 605, 606, 607, 608, 609, 610, 611, 612, 613, 614, 615, 616, 617, 618, 619, 620, 621, 622, 623, 624, 625, 626, 627, 628, 629, 630, 631, 632, 633, 634, 635, 636, 637, 638, 639, 640, 641, 642, 643, 644, 645, 646, 647, 648, 649, 650, 651, 652, 653, 654, 655, 656, 657, 658, 659, 660, 661, 662, 663, 664, 665, 666, 667, 668, 669, 670, 671, 672, 673, 674, 675, 676, 677, 678, 679, 680, 681, 682, 683, 684, 685, 686, 687, 688, 689, 690, 691, 692, 693, 694, 695, 696, 697, 698, 699, 700, 701, 702, 703, 704, 705, 706, 707, 708, 709, 710, 711, 712, 713, 714, 715, 716, 717, 718, 719, 720, 721, 722, 723, 724, 725, 726, 727, 728, 729, 730, 731, 732, 733, 734, 735, 736, 737, 738, 739, 740, 741, 742, 743, 744, 745, 746, 747, 748, 749, 750, 751, 752, 753, 754, 755, 756, 757, 758, 759, 760, 761, 762, 763, 764, 765, 766, 767, 768, 769, 770, 771, 772, 773, 774, 775, 776, 777, 778, 779, 780, 781, 782, 783, 784, 785, 786, 787, 788, 789, 790, 791, 792, 793, 794, 795, 796, 797, 798, 799, 800, 801, 802, 803, 804, 805, 806, 807, 808, 809, 810, 811, 812, 813, 814, 815, 816, 817, 818, 819, 820, 821, 822, 823, 824, 825, 826, 827, 828, 829, 830, 831, 832, 833, 834, 835, 836, 837, 838, 839, 840, 841, 842, 843, 844, 845, 846, 847, 848, 849, 850, 851, 852, 853, 854, 855, 856, 857, 858, 859, 860, 861, 862, 863, 864, 865, 866, 867, 868, 869, 870, 871, 872, 873, 874, 875, 876, 877, 878, 879, 880, 881, 882, 883, 884, 885, 886, 887, 888, 889, 890, 891, 892, 893, 894, 895, 896, 897, 898, 899, 900, 901, 902, 903, 904, 905, 906, 907, 908, 909, 910, 911, 912, 913, 914, 915, 916, 917, 918, 919, 920, 921, 922, 923, 924, 925, 926, 927, 928, 929, 930, 931, 932, 933, 934, 935, 936, 937, 938, 939, 940, 941, 942, 943, 944, 945, 946, 947, 948, 949, 950, 951, 952, 953, 954, 955, 956, 957, 958, 959, 960, 961, 962, 963, 964, 965, 966, 967, 968, 969, 970, 971, 972, 973, 974, 975, 976, 977, 978, 979, 980, 981, 982, 983, 984, 985, 986, 987, 988, 989, 990, 991, 992, 993, 994, 995, 996, 997, 998, 999, 1000	PREPARED BY AS ARCHITECT	REVIEWED BY PROF. ALBERTO B. GUALLO VP FOR ADMINISTRATION	APPROVED BY DR. EMMANUEL C. DE GUZMAN PRESIDENT	UNIT CHARGED AS BLDG. CASE NO. _____ DATE ISSUED _____ DATE ISSUED _____	QUANTITY A-17
--	---	------------------------------------	---	---	--	-------------------------

(02) 8713 5968 | dcoe_chair@gmail.com
 RM322 CEA BLDG. NDC COMPOUND,
 ANONAS COR. PUREZA STREETS, STA. MESA, MANILA





POLYTECHNIC UNIVERSITY OF THE PHILIPPINES
 COLLEGE OF ENGINEERING
COMPUTER ENGINEERING DEPARTMENT

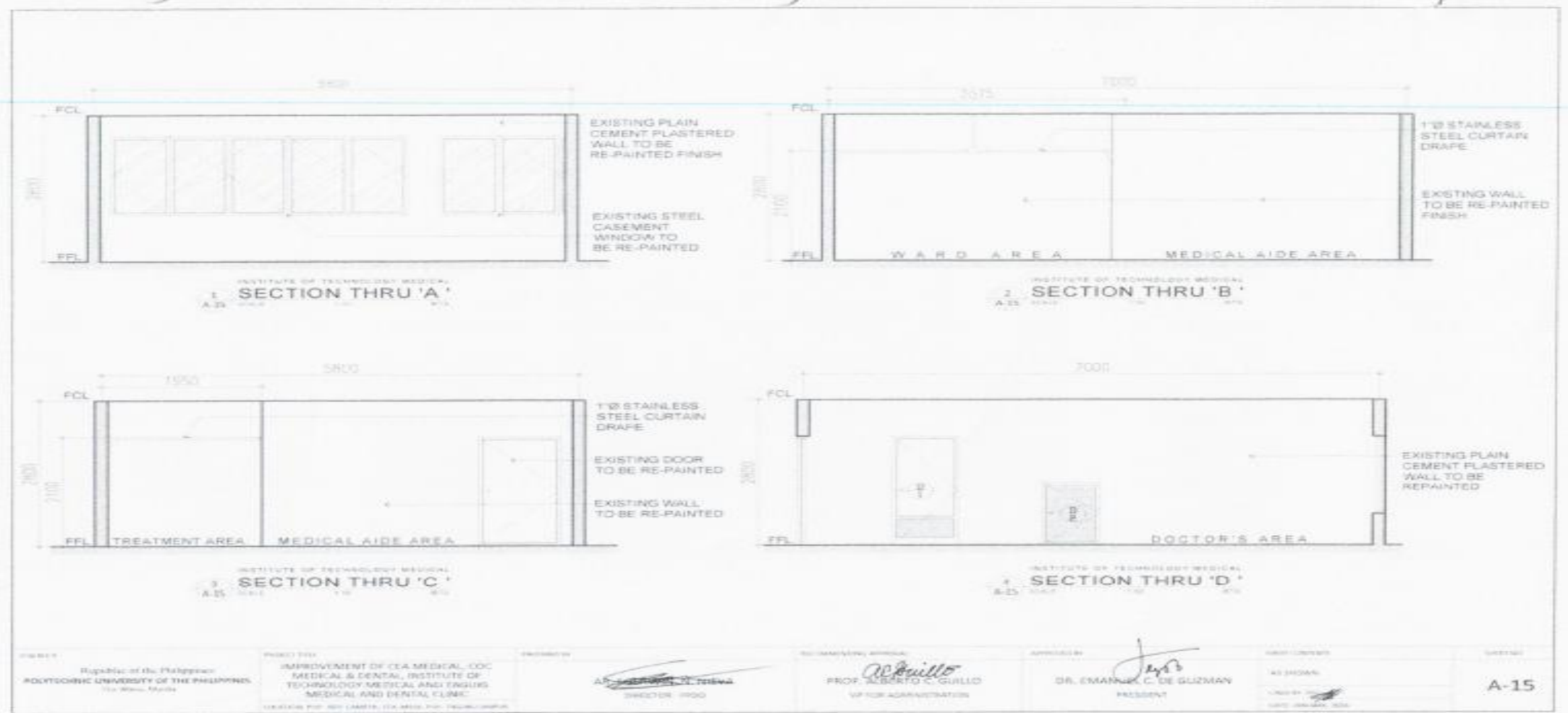







(02) 8713 5968 | dcoe_chair@gmail.com
 RM322 CEA BLDG. NDC COMPOUND,
 ANONAS COR. PUREZA STREETS, STA. MESA, MANILA

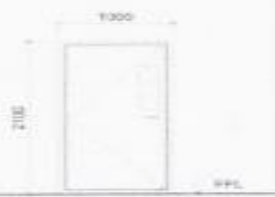



POLYTECHNIC UNIVERSITY OF THE PHILIPPINES
COLLEGE OF ENGINEERING
COMPUTER ENGINEERING DEPARTMENT

DOOR PROFILE	TYPE	DESCRIPTION	DOOR PROFILE	TYPE	DESCRIPTION	DOOR PROFILE	TYPE	DESCRIPTION
	D 1 SWING TYPE PANEL DOOR	FLUSH HOLLOW CORE MARINE PLYWOOD DOOR W/ GLASS WINDOW		D 2 SWING TYPE PANEL DOOR	FLUSH HOLLOW CORE MARINE PLYWOOD DOOR W/ GLASS WINDOW		D 3 SWING TYPE FLUSH DOOR	FLUSH HOLLOW CORE MARINE PLYWOOD DOOR WITH LOUVER
		LOCATION			LOCATION			LOCATION
	QUANTITY	COC DENTAL CLINIC MAIN DOOR		QUANTITY	CEA MEDICAL CLINIC - DOCTOR'S OFFICE		QUANTITY	COC DENTAL AND MEDICAL CLINIC TOILET DOOR
	1 SET			2 SETS			2 SETS	
DOOR PROFILE	TYPE	DESCRIPTION	WINDOW PROFILE	TYPE	DESCRIPTION	WINDOW PROFILE	TYPE	DESCRIPTION
	D 2 SWING TYPE PANEL DOOR	FLUSH HOLLOW CORE MARINE PLYWOOD DOOR W/ GLASS WINDOW		W 1 AWNING WINDOW	1/4" THK CLEAR GLASS ON ALUMINUM FRAMED AWNING WINDOW- ANALOK FINISH		W 2 AWNING WINDOW	1/4" THK CLEAR GLASS ON ALUMINUM FRAMED AWNING WINDOW- ANALOK FINISH
		LOCATION			LOCATION			LOCATION
	QUANTITY	COC DENTAL ROOM	FINISHED FLOOR LINE	QUANTITY	COC DENTAL CLINIC TOILET	FINISHED FLOOR LINE	QUANTITY	COC DENTAL CLINIC TOILET
	1 SET			1 SET			1 SET	

CEA MEDICAL CLINIC
SCHEDULE OF DOORS AND WINDOWS



1/8\"/>

POLYTECHNIC UNIVERSITY OF THE PHILIPPINES 974, MESA, MANILA	PROJECT TITLE IMPROVEMENT OF CEA MEDICAL, COC MEDICAL & DENTAL, INSTITUTE OF TECHNOLOGY MEDICAL AND TARIANS MEDICAL AND DENTAL CLINIC	PREPARED BY  DIRECTOR - PWD	REVISIONS/REVISIONS  PROF. ALBERTO C. GUILLO VP FOR ADMINISTRATION	APPROVED BY  DR. EMANUEL C. DE GUZMAN PRESIDENT	CHECKED BY AS SHOWN  DATE: JANUARY 2024	SHEET NO. A-13
--	--	---	--	---	---	--------------------------

(02) 8713 5968 | dcoe_chair@gmail.com
 RM322 CEA BLDG. NDC COMPOUND,
 ANONAS COR. PUREZA STREETS, STA. MESA, MANILA



ISO 9001:2015 CERTIFIED
 CERTIFICATE NUMBER: SCP0004130



POLYTECHNIC UNIVERSITY OF THE PHILIPPINES
 COLLEGE OF ENGINEERING
COMPUTER ENGINEERING DEPARTMENT

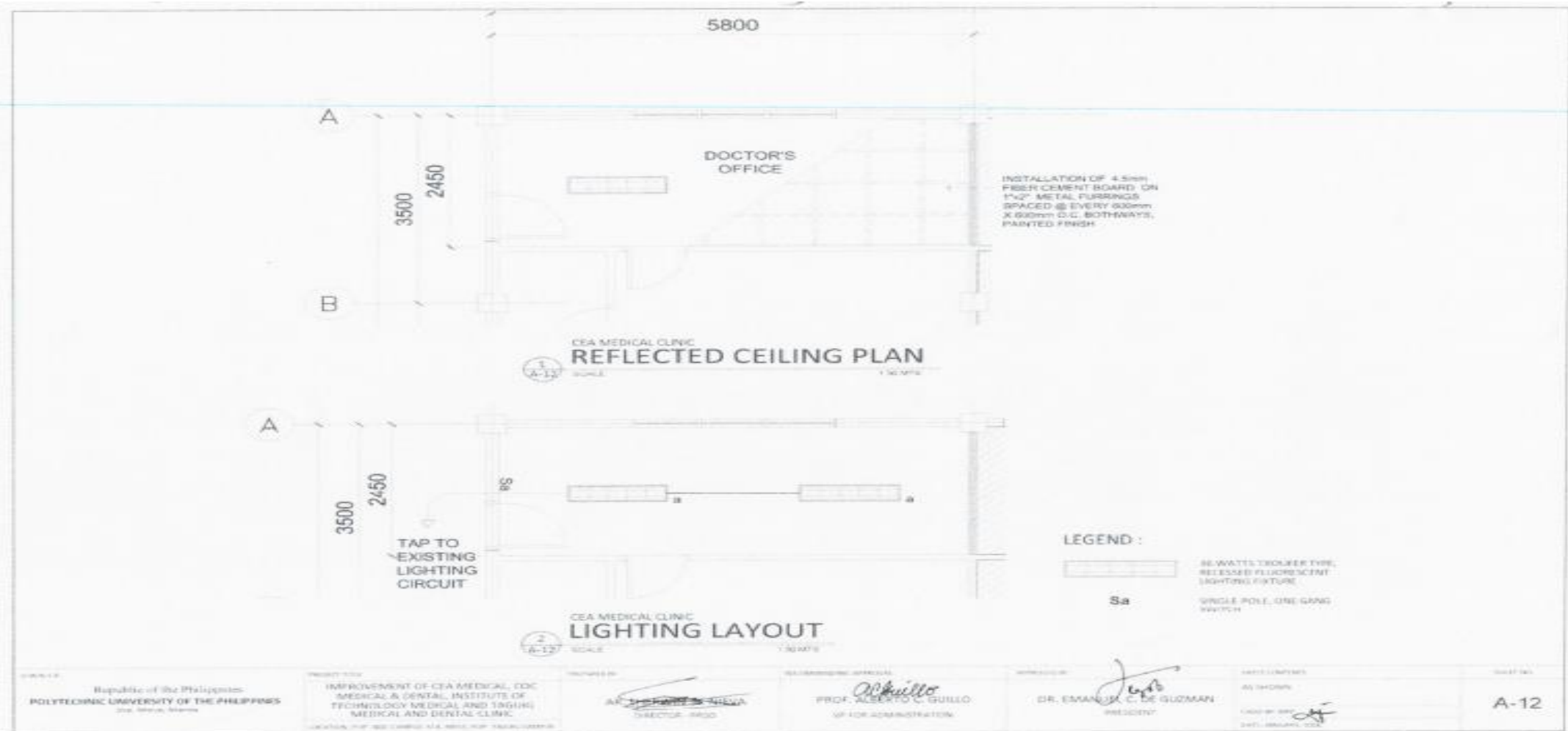

(02) 8713 5968 | dcoe_chair@gmail.com
 RM322 CEA BLDG. NDC COMPOUND,
 ANONAS COR. PUREZA STREETS, STA. MESA, MANILA





POLYTECHNIC UNIVERSITY OF THE PHILIPPINES
 COLLEGE OF ENGINEERING
COMPUTER ENGINEERING DEPARTMENT

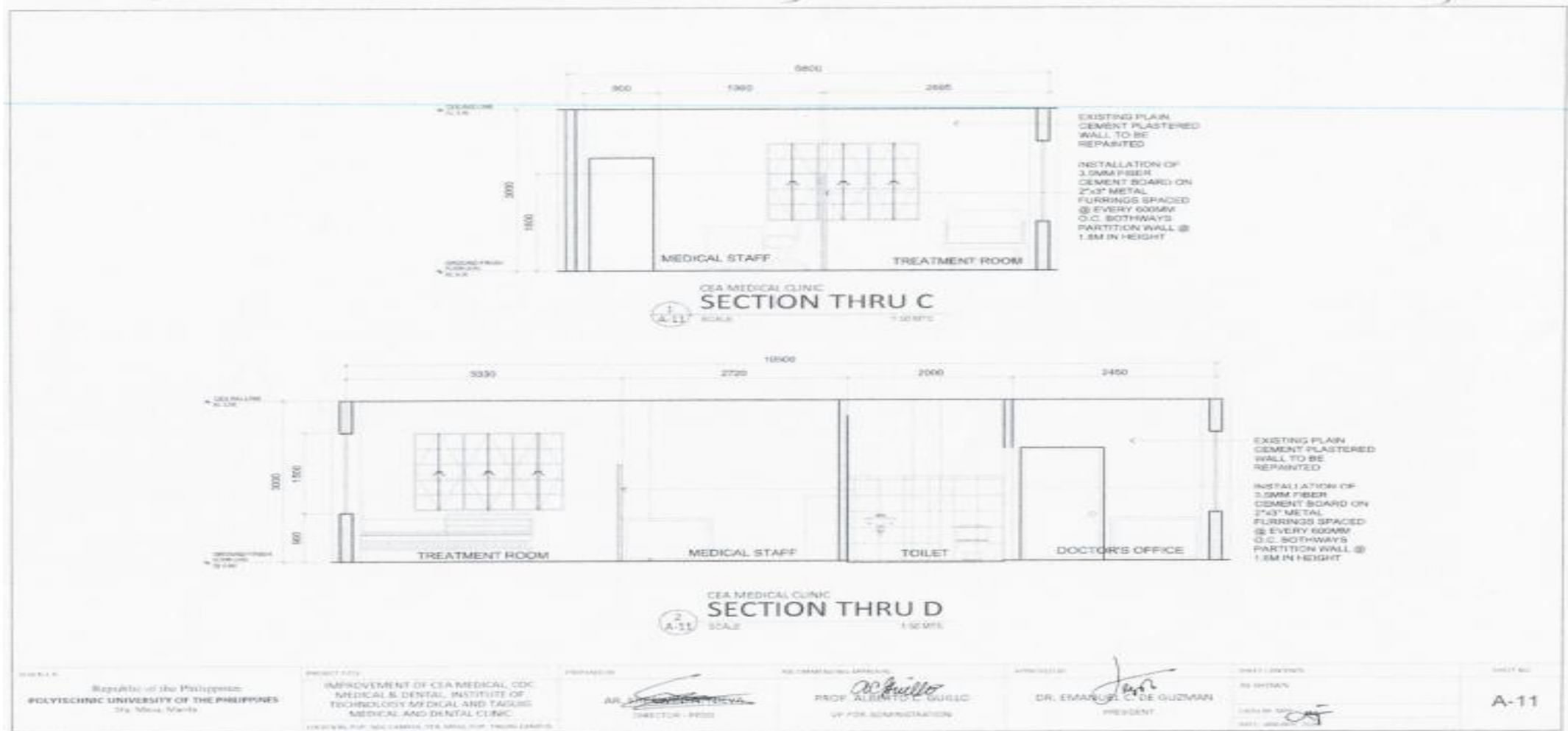

(02) 8713 5968 | dcoe_chair@gmail.com
 RM322 CEA BLDG. NDC COMPOUND,
 ANONAS COR. PUREZA STREETS, STA. MESA, MANILA





POLYTECHNIC UNIVERSITY OF THE PHILIPPINES
 COLLEGE OF ENGINEERING
COMPUTER ENGINEERING DEPARTMENT



(02) 8713 5968 | dcoe_chair@gmail.com
 RM322 CEA BLDG. NDC COMPOUND,
 ANONAS COR. PUREZA STREETS, STA. MESA, MANILA





POLYTECHNIC UNIVERSITY OF THE PHILIPPINES
 COLLEGE OF ENGINEERING
COMPUTER ENGINEERING DEPARTMENT

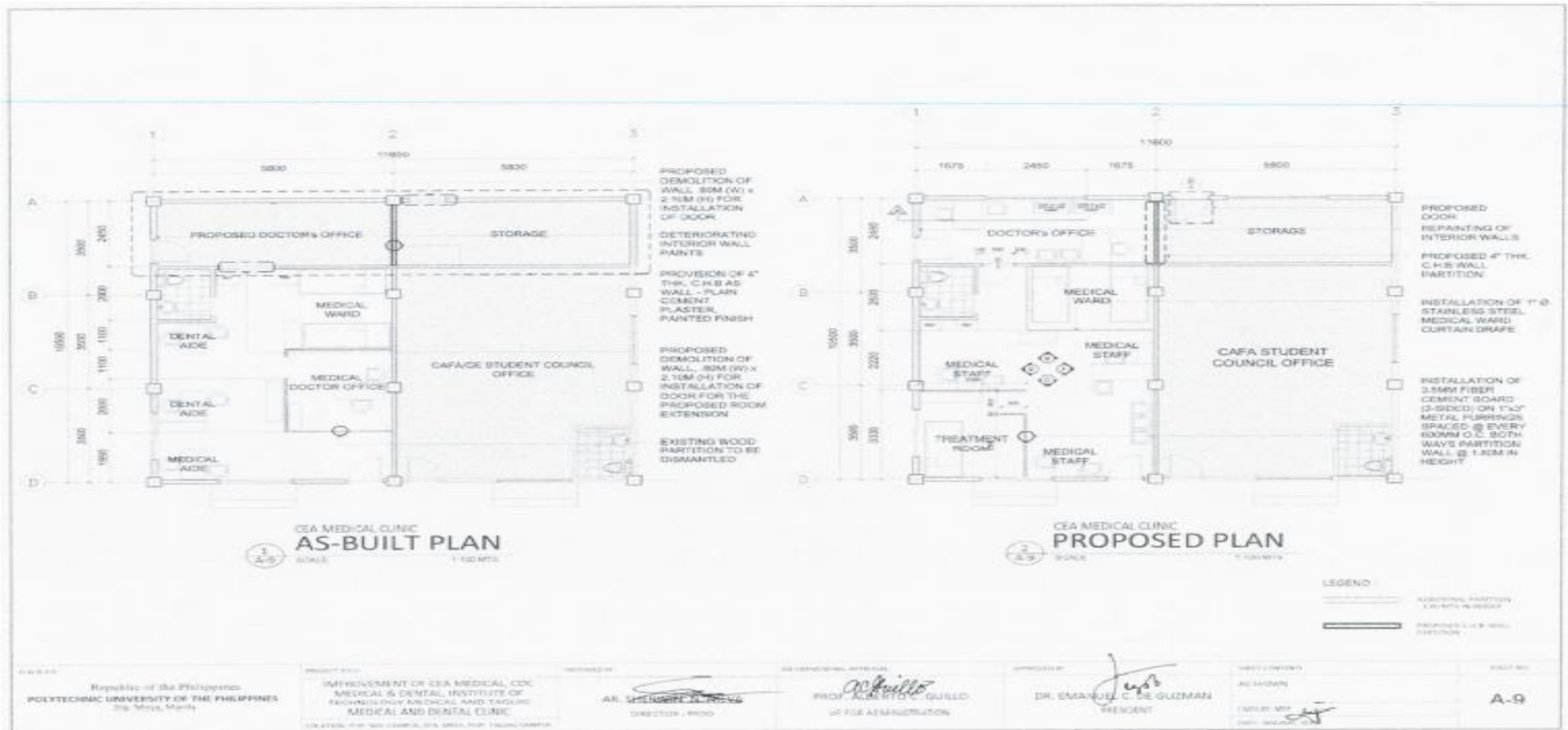

(02) 8713 5968 | dcoe_chair@gmail.com
 RM322 CEA BLDG. NDC COMPOUND,
 ANONAS COR. PUREZA STREETS, STA. MESA, MANILA



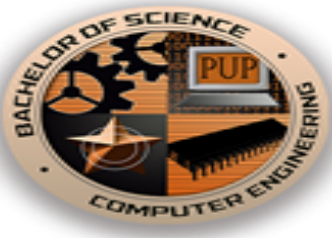

POLYTECHNIC UNIVERSITY OF THE PHILIPPINES
 COLLEGE OF ENGINEERING
COMPUTER ENGINEERING DEPARTMENT

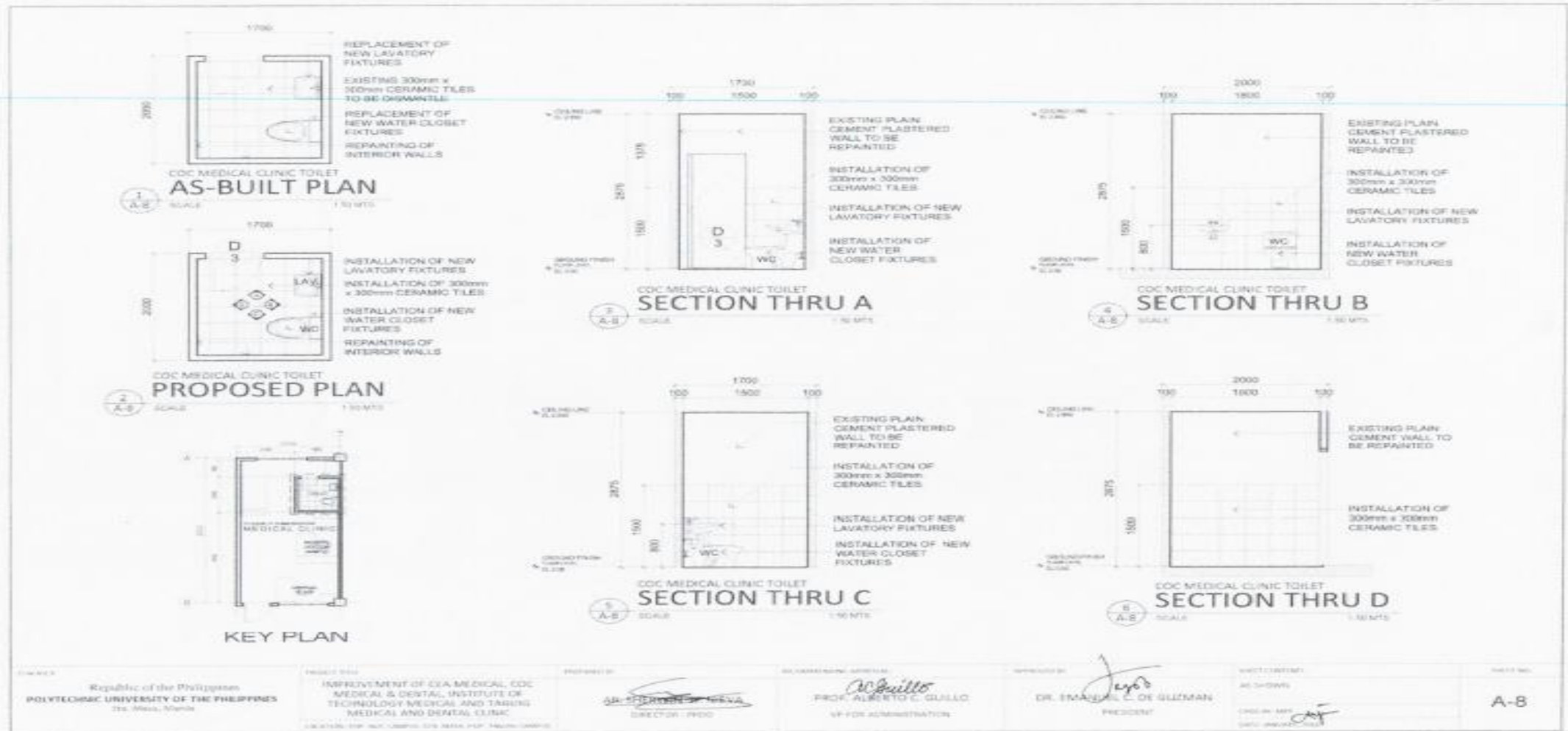

(02) 8713 5968 | dcoe_chair@gmail.com
 RM322 CEA BLDG. NDC COMPOUND,
 ANONAS COR. PUREZA STREETS, STA. MESA, MANILA





POLYTECHNIC UNIVERSITY OF THE PHILIPPINES
 COLLEGE OF ENGINEERING
COMPUTER ENGINEERING DEPARTMENT

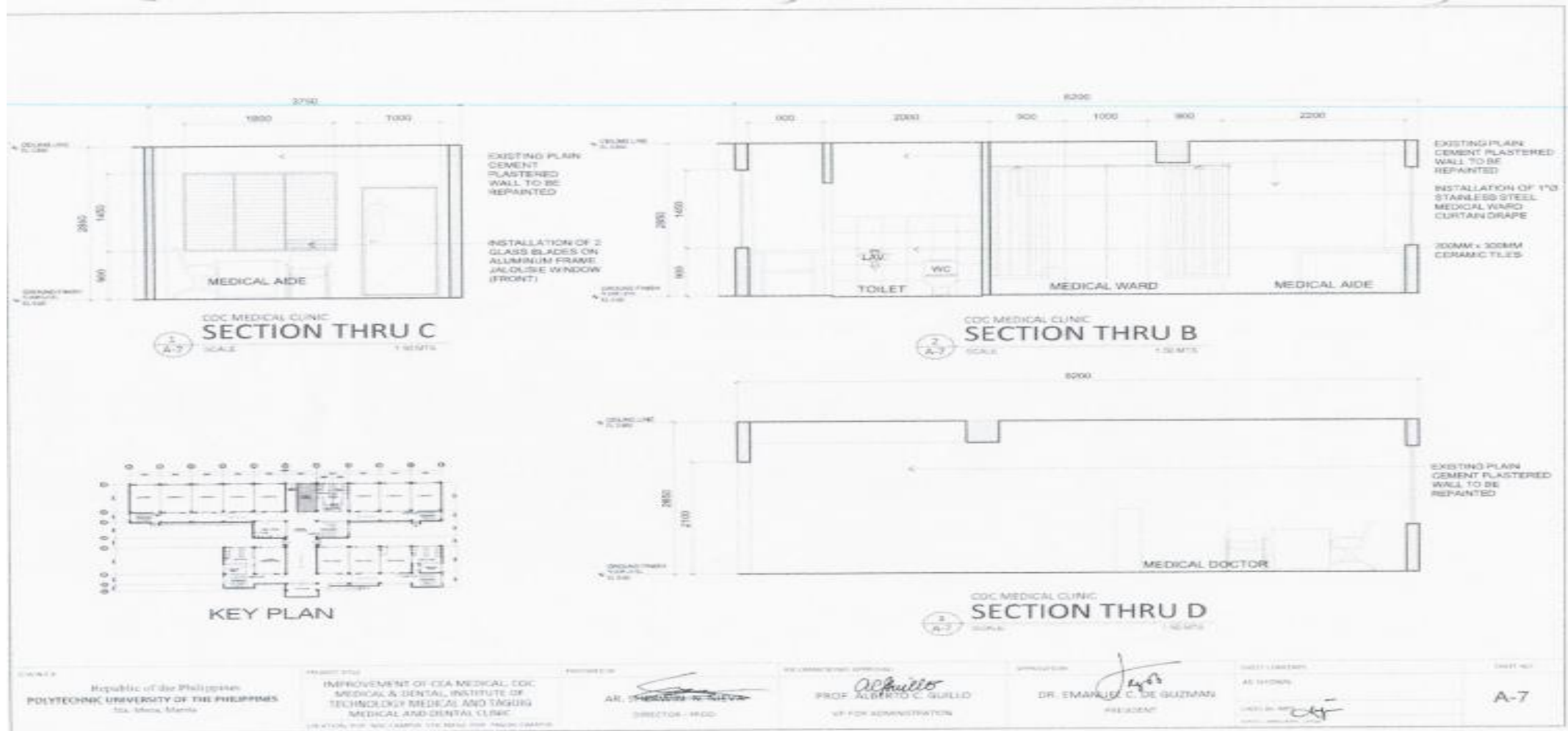

(02) 8713 5968 | dcoe_chair@gmail.com
 RM322 CEA BLDG. NDC COMPOUND,
 ANONAS COR. PUREZA STREETS, STA. MESA, MANILA





**POLYTECHNIC UNIVERSITY OF THE PHILIPPINES
COLLEGE OF ENGINEERING
COMPUTER ENGINEERING DEPARTMENT**



(02) 8713 5968 | dcoe_chair@gmail.com
 RM322 CEA BLDG. NDC COMPOUND,
 ANONAS COR. PUREZA STREETS, STA. MESA, MANILA





**POLYTECHNIC UNIVERSITY OF THE PHILIPPINES
COLLEGE OF ENGINEERING
COMPUTER ENGINEERING DEPARTMENT**

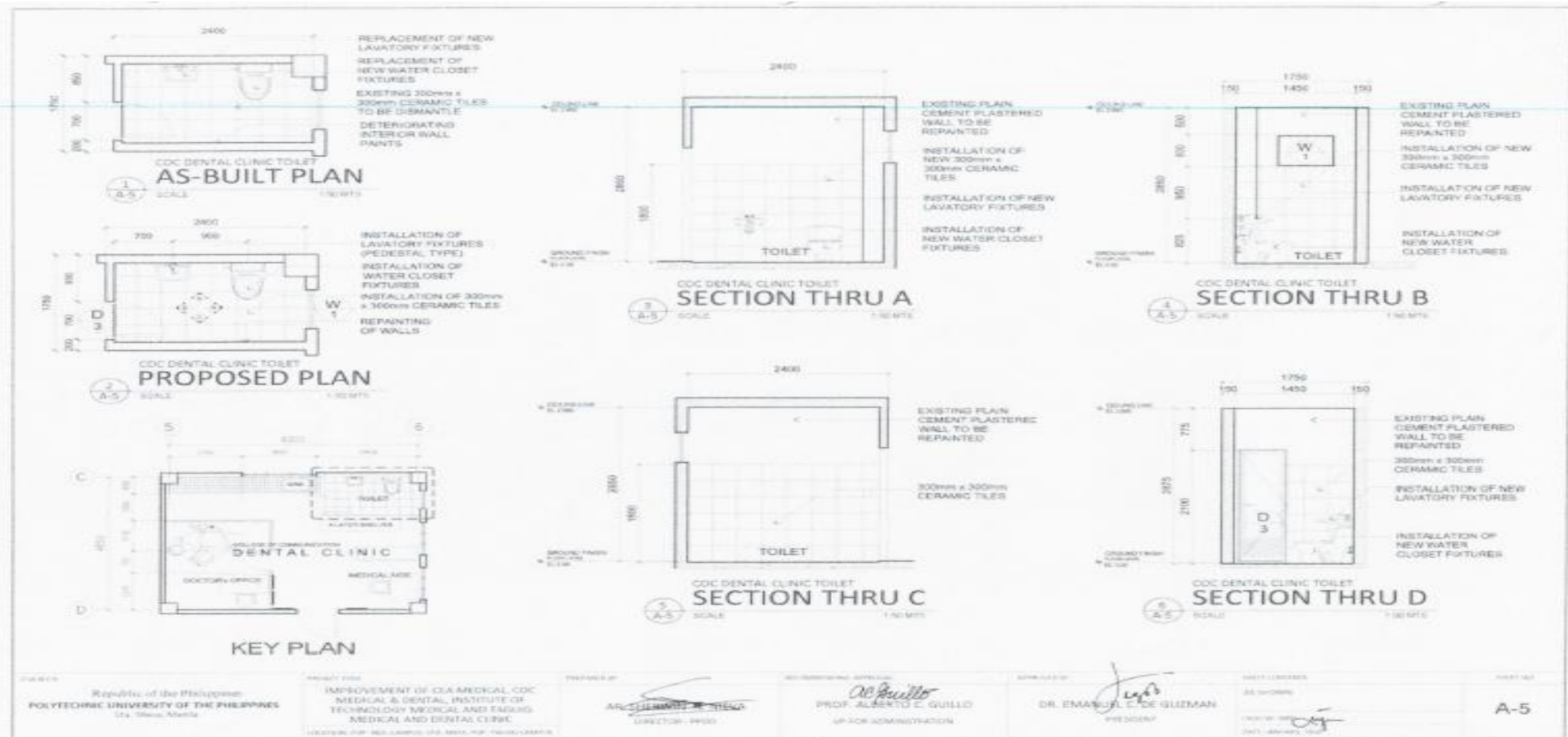

(02) 8713 5968 | dcoe_chair@gmail.com
 RM322 CEA BLDG. NDC COMPOUND,
 ANONAS COR. PUREZA STREETS, STA. MESA, MANILA





POLYTECHNIC UNIVERSITY OF THE PHILIPPINES
 COLLEGE OF ENGINEERING
COMPUTER ENGINEERING DEPARTMENT

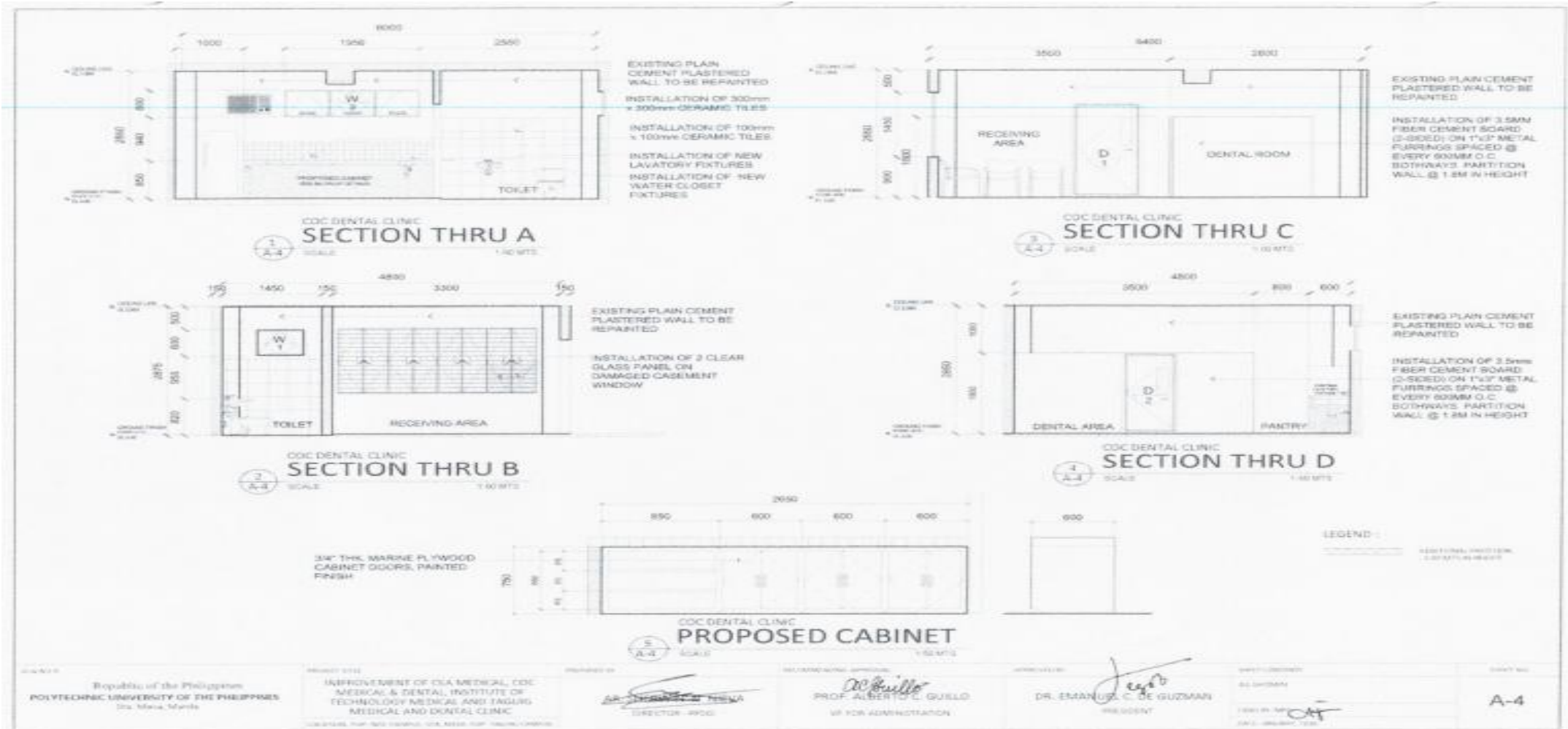

(02) 8713 5968 | dcoe_chair@gmail.com
 RM322 CEA BLDG. NDC COMPOUND,
 ANONAS COR. PUREZA STREETS, STA. MESA, MANILA





**POLYTECHNIC UNIVERSITY OF THE PHILIPPINES
COLLEGE OF ENGINEERING
COMPUTER ENGINEERING DEPARTMENT**

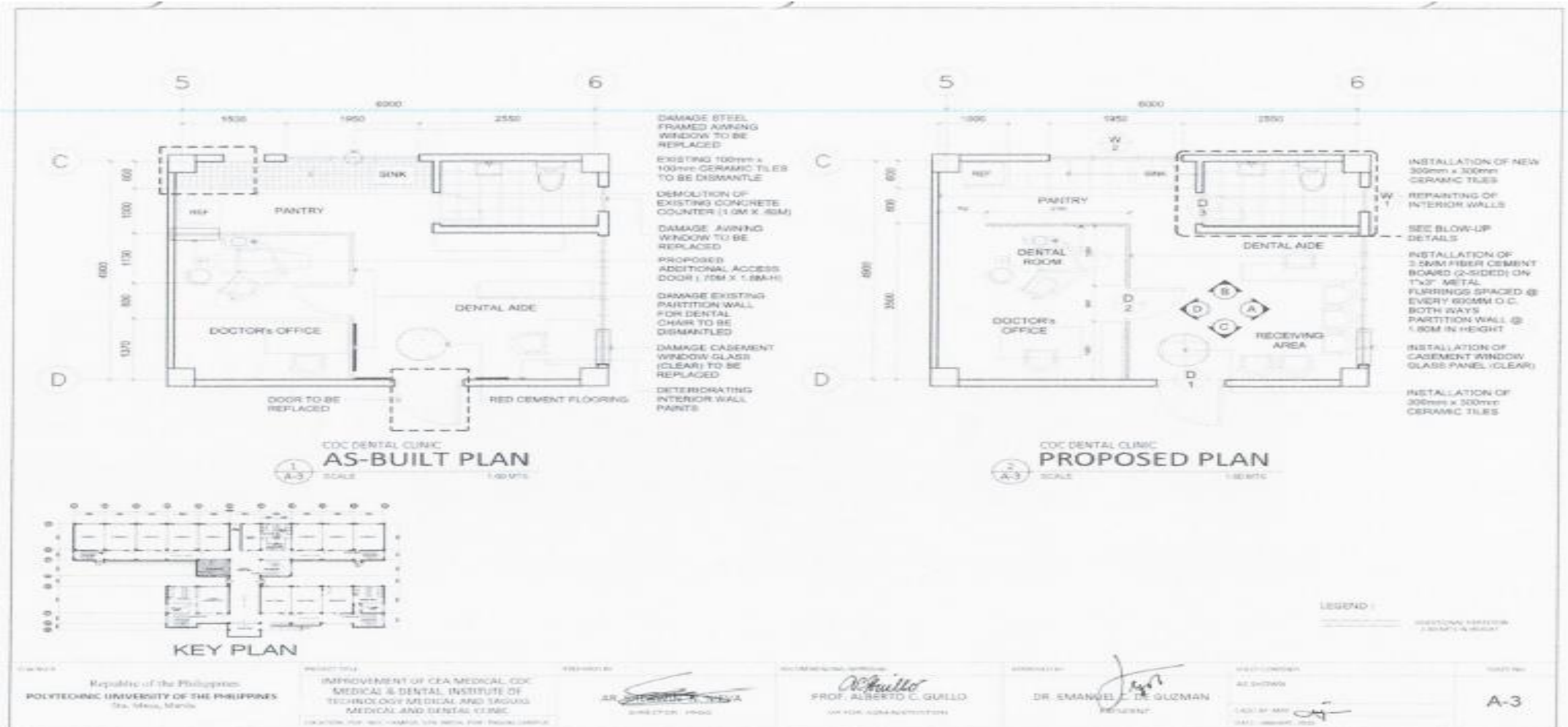

(02) 8713 5968 | dcoe_chair@gmail.com
 RM322 CEA BLDG. NDC COMPOUND,
 ANONAS COR. PUREZA STREETS, STA. MESA, MANILA





POLYTECHNIC UNIVERSITY OF THE PHILIPPINES
COLLEGE OF ENGINEERING
COMPUTER ENGINEERING DEPARTMENT



(02) 8713 5968 | dcoe_chair@gmail.com
 RM322 CEA BLDG. NDC COMPOUND,
 ANONAS COR. PUREZA STREETS, STA. MESA, MANILA





POLYTECHNIC UNIVERSITY OF THE PHILIPPINES
COLLEGE OF ENGINEERING
COMPUTER ENGINEERING DEPARTMENT

RECEPTION AND CONSULTATION ROOM



One of the reception or consultation room of the University clinic and accommodates students in need of medical guidance



POLYTECHNIC UNIVERSITY OF THE PHILIPPINES
COLLEGE OF ENGINEERING
COMPUTER ENGINEERING DEPARTMENT

TREATMENT ROOM



University Clinic Treatment Room for injured and sick patient



POLYTECHNIC UNIVERSITY OF THE PHILIPPINES
COLLEGE OF ENGINEERING
COMPUTER ENGINEERING DEPARTMENT

TREATMENT ROOM



The University Clinic has enough space to have treatment room and reception room along with enough lighting and ventilation to accommodate all of the patients



POLYTECHNIC UNIVERSITY OF THE PHILIPPINES
COLLEGE OF ENGINEERING
COMPUTER ENGINEERING DEPARTMENT

MEDICAL CLINIC



This is the University's Clinic located at the College of Engineering and Architecture Building



POLYTECHNIC UNIVERSITY OF THE PHILIPPINES
COLLEGE OF ENGINEERING
COMPUTER ENGINEERING DEPARTMENT

COMFORT ROOM



Comfort room inside of the University Clinic



POLYTECHNIC UNIVERSITY OF THE PHILIPPINES
COLLEGE OF ENGINEERING
COMPUTER ENGINEERING DEPARTMENT



CEA MEDICAL OBSERVATION AREA



CEA MEDICAL TOILET



POLYTECHNIC UNIVERSITY OF THE PHILIPPINES
COLLEGE OF ENGINEERING
COMPUTER ENGINEERING DEPARTMENT

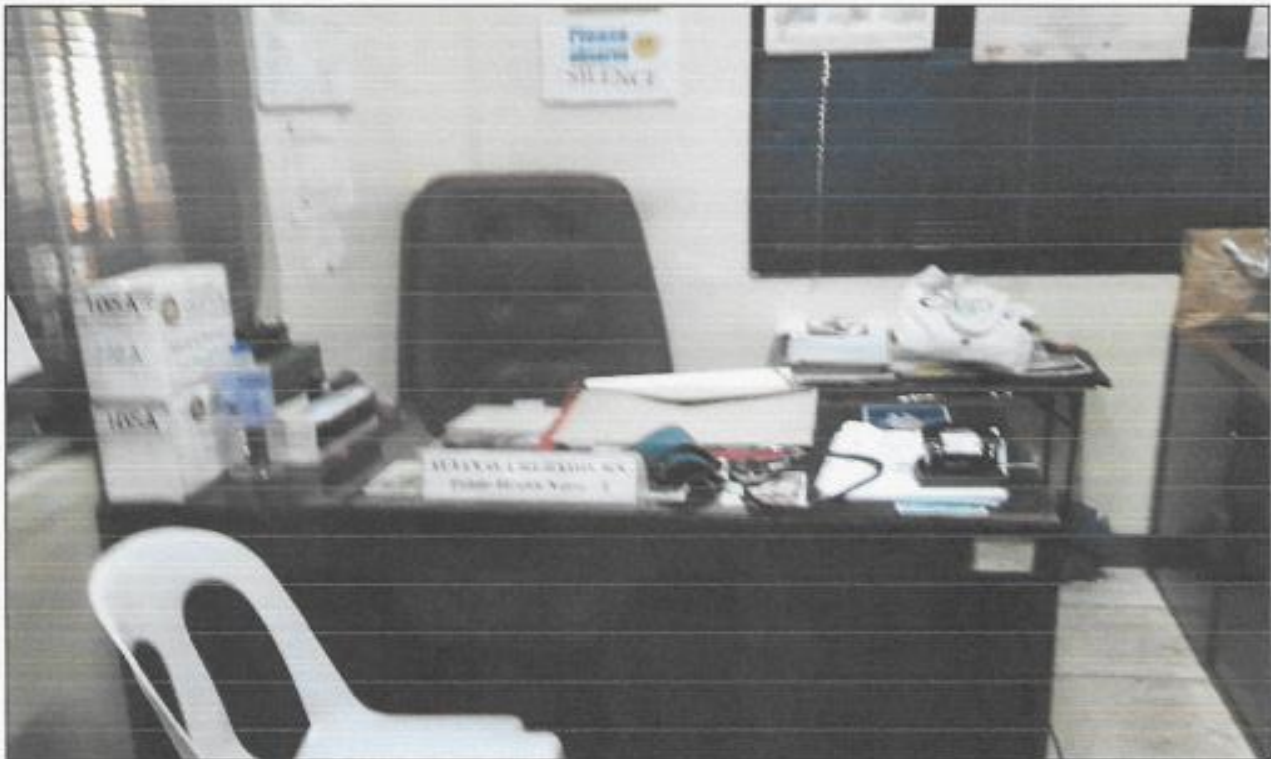

CEA MEDICAL RECEPTION AREA



CEA MEDICAL RECORD SECTION



POLYTECHNIC UNIVERSITY OF THE PHILIPPINES
COLLEGE OF ENGINEERING
COMPUTER ENGINEERING DEPARTMENT

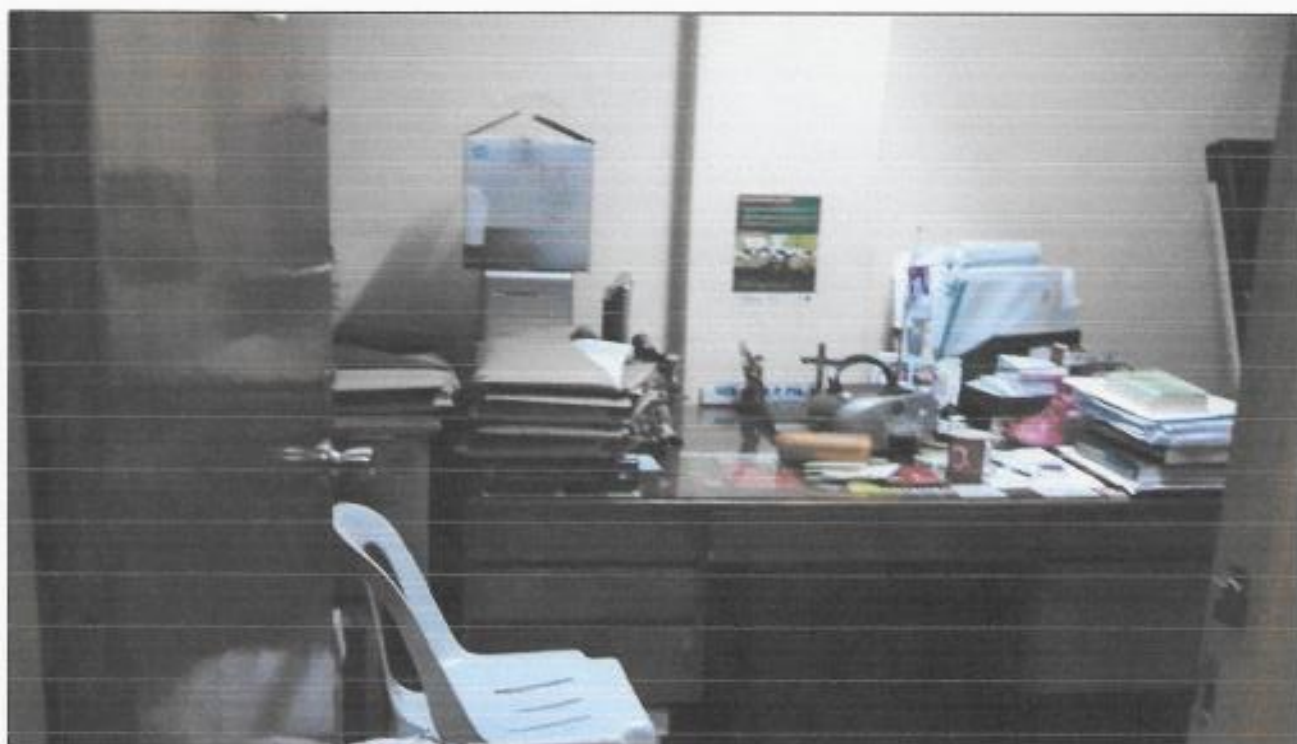

CEA MEDICAL CONSULTATION ROOM



CEA MEDICAL WAITING AREA



POLYTECHNIC UNIVERSITY OF THE PHILIPPINES
COLLEGE OF ENGINEERING
COMPUTER ENGINEERING DEPARTMENT



RECEPTION AREA



POLYTECHNIC UNIVERSITY OF THE PHILIPPINES
COLLEGE OF ENGINEERING
COMPUTER ENGINEERING DEPARTMENT



DENTAL CLINIC DURING TREATMENT



POLYTECHNIC UNIVERSITY OF THE PHILIPPINES
COLLEGE OF ENGINEERING
COMPUTER ENGINEERING DEPARTMENT



CONSULTATION AND TREATMENT AREA



POLYTECHNIC UNIVERSITY OF THE PHILIPPINES
COLLEGE OF ENGINEERING
COMPUTER ENGINEERING DEPARTMENT



DURING OBSERVATION



DURING DOCTOR'S CONSULTATION



POLYTECHNIC UNIVERSITY OF THE PHILIPPINES
COLLEGE OF ENGINEERING
COMPUTER ENGINEERING DEPARTMENT



CONSULTATION AND TREATMENT AREA



DURING CONSULTATION